



YITPI YARTAPUULTIKU

ABORIGINAL CULTURAL DESTINATION
PORT ADELAIDE

EXPRESSION OF INTEREST HOSPITALITY PROGRAM PACKAGE

Puki Puki tampi'dlu, nartangka wapi'dlu, mamintyaria tarrkarri tai'dlu

Welcome. Let us recognise the past, act in the present and build a better future.

At the City of PAE, we have been working closely with local Kurna Custodians and the PAE Aboriginal Advisory Panel to create Yitpi Yartapuultiku — a new Aboriginal Cultural destination in Port Adelaide.

Expressions of Interest (EOI) are being sought for Yitpi Yartapuultiku Hospitality Program Package (YYHPP): exclusively for Yitpi Yartapuultiku" Port Adelaide. Receiving sole proprietor and or collaboration, to deliver management of the Kitchen and Café, Hospitality Training and Catering Provision.

This is well-presented and rare opportunity for suitably qualified proponents to be established among a new and exciting destination where a range of programs and services and community life will flourish, allowing for a developed YYHPP to be delivered at a qualified standard to meet the YYHPP objectives.

It is anticipated that applicants acknowledge in their submissions that the YYHPP offers a quality commercial kitchen with café facilities with access to a large potential client base to draw upon during operations, and that there is suitable financial benefit for Council and the operator.

Applicants are invited to submit the EOI with their proposed use and capacity and experience to operate a commercial kitchen under a negotiated term lease. Council is open to consider a variety of potential operations across the YYHPP.

Council will assess the EOI's and then negotiate with the selected applicant to formalise the specified operations, remuneration and conditions of the lease agreement.

Yitpi Yartapuultiku is a unique form of community facility that shall meet the specific needs and aspirations for Aboriginal and Torres Strait Islander peoples, and support Council's long-term City Plan priorities for the City.

The YYHPP is expected to deliver hospitality training, cafe coordination, on-site and off-site catering and hands on experience for students in an industrial twelve station training kitchen.

Key objectives of the YYHPP Initiative will increase the project Economic, Social and Stakeholder Experience Impacts.

- Provision of qualified and unqualified skill training and opportunity for future employment
- Generates substantial direct and indirect revenues
- Provides hands on qualified training experience
- Provides greater stakeholder and users experience
- Will enhance a range of other programs and activities

It is envisaged that the YYHPP initiative will by sole proprietor or through a collaboration approach:

- Engage and manage the operations of Registered Training Organisation
- Deliver Hospitality Qualifications
- Manage the Café
- Provide food and beverage to the site (within capacity)
- Coordinate with collaborate partners
- Target training and employment organisation to seek suitable participants and provide Hospitality Student support
- Target a key outlet from the Department of Children and Education: Work-about Centre, Clontarf Academy and the South Australian Aboriginal Secondary Training Academy to seek suitable participants and provide Hospitality Student support.
- Provide Mentoring and alternative cultural training to enrolled participants within the Hospitality Qualifications training
- Be willing to negotiate the use of the Kitchen between other RTO, Hospitality outlets and community cooking programs
- Ability to provide First Nation catering product
- Certain restrictions may apply to the operation of the YYHPP
- Maintain the ambience and tradition of the premises and the Cultural site precinct

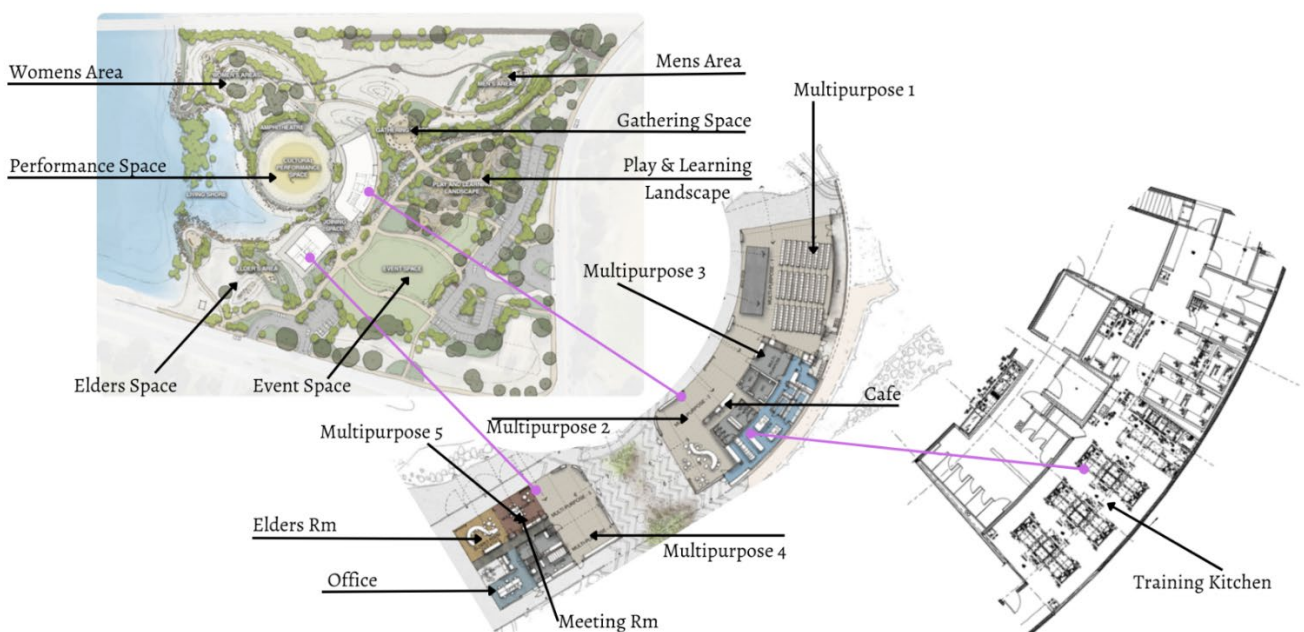

The kitchen includes a twelve-station kitchen to include qualified hospitality training and hands on experience in a food industry and establish a provider to offer ongoing catering on and off site. Recommended to qualify the function and operate at financial cost capability for training and offer financial income for YYHPP provider. A Café further adds to the student experience yet will increasing foot traffic into Yitpi Yartapuultiku.

We welcome expressions of interest from Registered RTO's Organisations, Business, individuals, or groups and be a part of the Yitpi Yartapuultiku will invest in and embrace collaborations and partnerships where we aim to implement three planning approaches; Council Led, Co-Led and Community Led outcomes that shall:

- Build a supportive scaffolding of community assets, resources and creative capacity for cultural experiences and participation that support and strengthen the cultural life of our community.
- Grow and develop a shared understanding of our unique heritage and cultural identity, along with a commitment to protecting our cultural spaces, whilst sharing and celebrate this with our community and visitors.
- Build upon our City's reputation of creativity and innovation in our arts and cultural industry and contribute to our regional economy.

We are looking for Expressions of Interest that:

- Maintain the Yitpi Yartapuultiku vision: to welcome all people to a safe place; be a place to practice, share, celebrate and record past, present, and emerging; be a place for Aboriginal and non-Aboriginal people to learn, experience and be immersed together in culture; and be a place to all connect to Country.
- Recognise and respect cultural authority and cultural authenticity
- Sustain equitable access to Country and culture
- Uncover community values and expertise
- Secure Council-led, co-led and community-led outcomes
- Use collaboration and partnership to build a space that is vibrant and thriving
- Demonstrate innovation and/or test and refine concepts
- Build our capacity to drive place-based community development
- Secure Yitpi Yartapuultiku as an authentic and unique brand, place and space
- Help to enhance people's wellbeing and create a positive impact
- Provide local, regional, interstate, and international visitors with an opportunity to have an unforgettable, authentic, cultural experience

What is the Time Frame?

We are currently seeking expressions of interest in collaboration to deliver a Yitpi Yartapuultiku Hospitality Program Package; Kitchen and Café Management, Hospitality Training and Catering Provision from early 2025.

We are looking for Expressions of Interest from individuals, groups and organisations who would like to collaborate with the City of Port Adelaide Enfield. There will be several Expression of Interest Rounds.

How to Submit Your Expression of Interest

We are currently accepting submissions for Round 1. Closes March 30th, 2024

Your submission should include the following:

- A proposal of your YYHPP approach and management
- Recent examples of your kitchen / café operations, qualified training capability and catering services
- A brief summary of your interest in, and approach to, collaborating in the Yitpi Yartapuultiku Project

In your submission, you should also demonstrate an understanding of:

- The social, cultural, economic and community benefits that your service or program will bring to Yitpi Yartapuultiku and the broader community
- The space and technical medium that you intend to use or that you will require to implement all or part of the YYHPP Initiative

Please also provide your contact details in your submission, including:

- Your name
- Your phone number
- Your email address
- Your postal address

Please submit your Expression of Interest to:

Rodney Welch, Place Leader, Yitpi Yartapuultiku

- Email: rodney.welch@cityofpae.sa.gov.au
- Post: City of PAE, PO Box 110, Port Adelaide SA 5015

If You Need More Information or Assistance

If you have more questions about Yitpi Yartapuultiku or about how to submit an Expression of Interest, please feel free to visit the Yitpi Yartapuultiku project page on Participate PAE, our online engagement platform, at: participate.cityofpae.sa.gov.au/yitpiyartapuultiku

Alternatively, please feel free to contact:

- Rodney Welch, Place Leader, rodney.welch@cityofpae.sa.gov.au
- Matthew Rose, Project Lead, matthew.rose@cityofpae.sa.gov.au